



PRODUCT UPGRADE SHEET

SSR/SSX/SSY 812 steel chains are obsolete

Rexnord FlatTop continuously develops new products for conveyors, but the current offering in the Rexnord®, MCC® and Marbett® product lines is also frequently reviewed: do these products still give the best fit to the needs of our customers and do they provide the best value for money?

As a part of this process we have decided to discontinue the SSR, SSX and SSY 812 chain types.

Many years ago Rexnord and MCC set the standard for stainless steel chains, reducing the gap between links from 2.8 to 1.6 mm. For applications requiring optimal product support, a small gap between the links is a must. Since the introduction of the narrow gap (now standard), the demand for chains with the large gap has slowed down.

Therefore chain type **SSR 812 will be discontinued**.

Rexnord has carried a range of stainless steel chains with superior flatness for critical applications, such as pressureless combiners. These applications, where products are conveyed at high speed, require the best sliding properties and optimal product support of the chain. The increasing capacity of filling lines feed the need for these high performance chains; so we are proud to announce the further improvement of the overall flatness for the complete series of SSC and MCC X-line stainless steel chains.

Therefore the less flat chain types **SSX and SSY will be discontinued**.

In the table below you will find details of the old and new chains:

Chain type	Code number	Material	Gap	Flatness	Status
			mm	mm	
SSR 812 - K325	10.001.21.110	Opti-Plus	2.8	0.15	Discontinued*
SSX 812 - K325	10.002.21.110	Opti-Plus	2.8	0.10	Discontinued*
SSY 812 - K325	10.007.21.110	Opti-Plus	1.6	0.10	Discontinued
SSC 812 - K325	10.006.21.110	Opti-Plus	1.6	0.08	Available
60 S 31 XM	762.69.31	60-series	1.6	0.08	Available

**For applications where a 2.8 mm gap is still required, for example if a small back flex radius is necessary to fit the conveyor construction, the MCC equivalent 60S31S (762.62.31) can be ordered.*

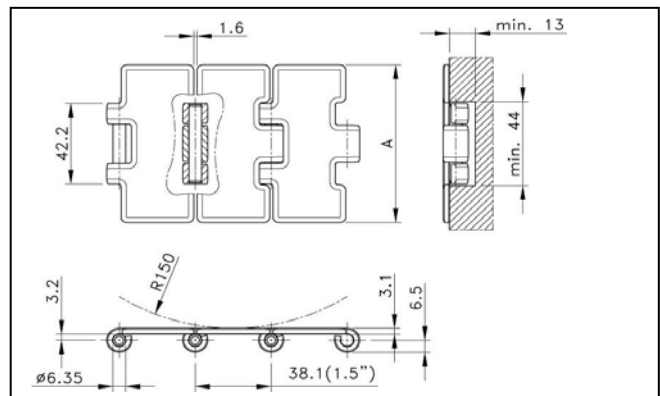

If you have a question regarding this topic, please contact your local Technical Support representative, phone +31 174 445 111.